

Multi-constellations **ANTENNA** Option B

The high gain precision GNSS antenna covers the **BeiDou B1, Galileo E1, GPS L1, GLONASS L1 and SBAS (WAAS, EGNOS, QZSS & MSAS)** frequency bands (1557 to 1606 MHz). They use circularly polarized signal reception technology over the entire bandwidth of the antenna.



Key Features

- **Weight:** 0.15 kg
- **Dimensions:** 65,5 mm x 21 mm (D x H)
- **Bandwidth (2dB):** 47 Mhz
- **Coulour:** White
- **Shape:** Conical

Mechanical characteristics

- **Vibration:** 3 axis, sweep = 15 min, sweep from 10 to 200 Hz: 3 g
- **Shock:** Vertical Axis: 50 g, each axe: 30 g
- **Ratio axis:** <2 dB typ., 3 dB max.
- **Mounting:** Permanent $\frac{3}{4}$ » (19mm) through-hole mounting Bracket: in L or in tube

Environmental characteristics

- **Requirements:** RoHS, REACH, et RED
- **Operating temperature:** -40°C to + 85°C
- **Storage temperature:** -45°C to +85°C
- **Humidity/Salt fog:** MIL-STD-810F Section 509,4
- **Waterproof:** IP67

FASTENING KIT INCLUDING

- 1 hollow tube 20cm long
- 1 plate
- M6 and M8 nuts
- M6 and M8 washers
- Fixing brackets

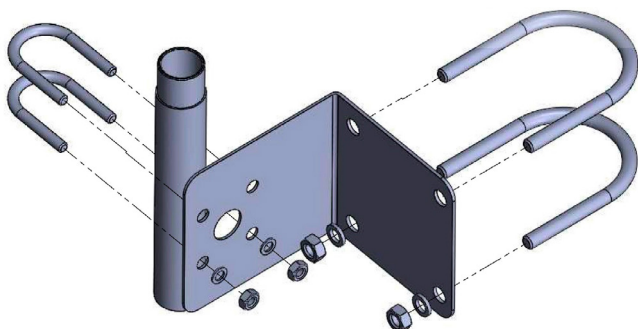

Electrical characteristics

- **Frequency band:** 1559 to 1606 MHz
- **Polarization:** RHCP
- **Amplification gain (LNA):** 40 dB min.,
- **Flatness gain:** +/- 2 dB, 1559 à 1606 MHz
- **Out-of-band discharge:**
 - f < 1500 MHz : >50 dB
 - f > 1640 MHz : >70 dB
- **VSWR output:** <1.5:1 typ. 1.8:1 max
- **Maximum noise:** 3 dB typ.
- **Main power:** 2,5 to 16 VDC nominal (max. 12VDC recommended)
- **Direct current:** 19 mA typ.
- **ESD Protection circuit:** 15 KV air discharge